

ELECTRICAL CONNECTION

Wiring information for **Triple-R 1000 Beacon** and **Triple-R 1000 Elite i-LBA** lamps are included in the lamp box.

★ — The red wire (Pin 30) connecting to the battery will need to be extended (cable and butt connector included).

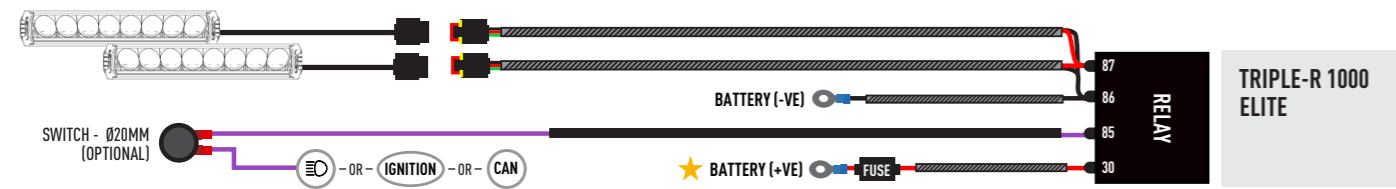
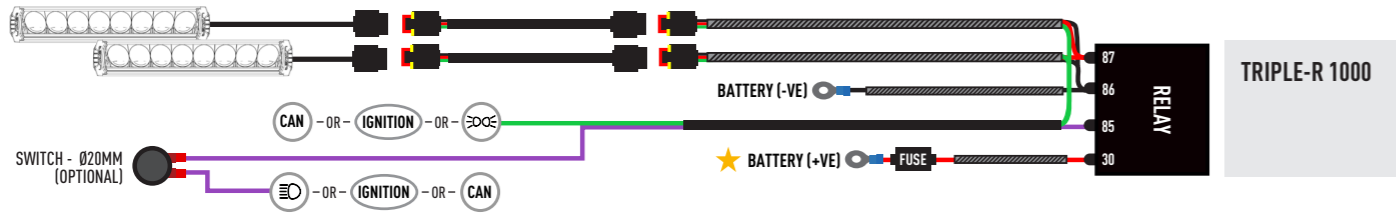

LAMP CONNECTOR INFORMATION

TRIPLE-R POSITION LIGHT FUNCTION (OPTIONAL)

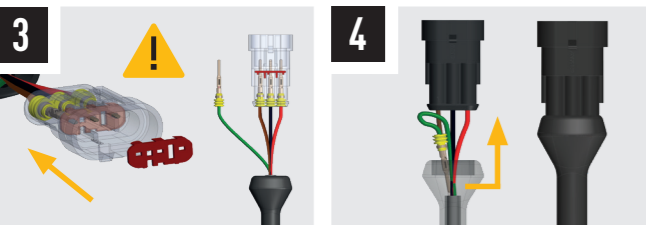
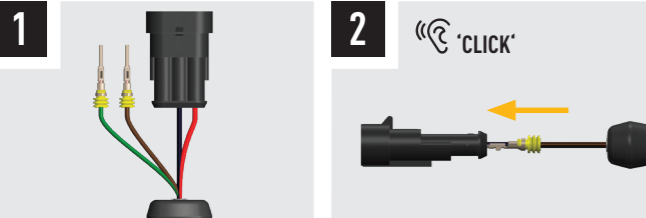

CANBUS INTEGRATION (SOLD SEPERATELY)

For vehicles where it is not possible to locate a 12V high beam signal, it will be necessary to take the high beam signal from the vehicle's CAN system. For connection options please visit the Lazer Lamps website, or contact your nearest dealer.

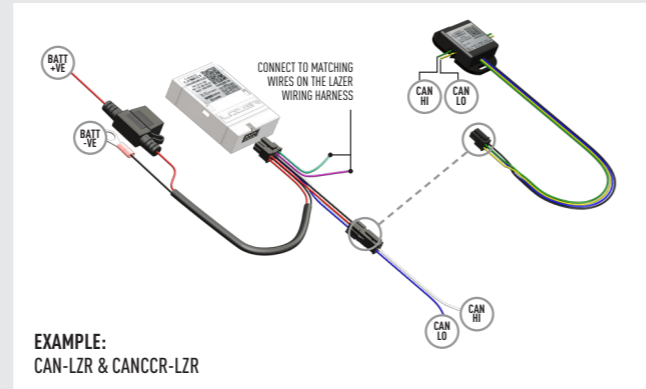

E9 UNECE REGULATIONS

Please scan the QR code to view all UNECE Certificates and information.



LAZER

HIGH PERFORMANCE LIGHTING

CHEVROLET SILVERADO 1500 LT (2022-2024) GRILLE KIT

FITTING INSTRUCTIONS



LAZER
HIGH PERFORMANCE LIGHTING
WWW.LAZERLAMPS.COM

We appreciate your purchase of a Lazer Lamps product, and value your feedback. If you would like to leave feedback on your Lazer experience, please head to the relevant product page on our website www.lazerlamps.com.

T +44 (0) 1992 677374
E sales@lazerlamps.com

Lazer Lamps Ltd, Calder House, Central Road
Harlow, Essex, CM20 2ST, UK

MADE IN THE UK /LAZERLAMPS

WHAT'S INCLUDED

- 4x Grille Mounting Brackets
- 4x Cutter Guides
- Anti-Theft Fasteners & Key
- Fitting Instructions

Additionally - Kit Includes:

- 2x Triple-R 1000 LED Lights
- 1x Two-Lamp Wiring Kit

TOOLS REQUIRED

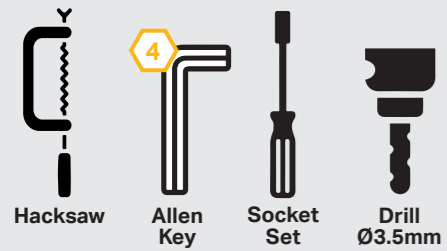

SIDE MOUNTING INFORMATION

Please use a thread seal compound (i.e. Loctite 222) to protect the lamp fastener from binding over time. See our T&Cs for more information.

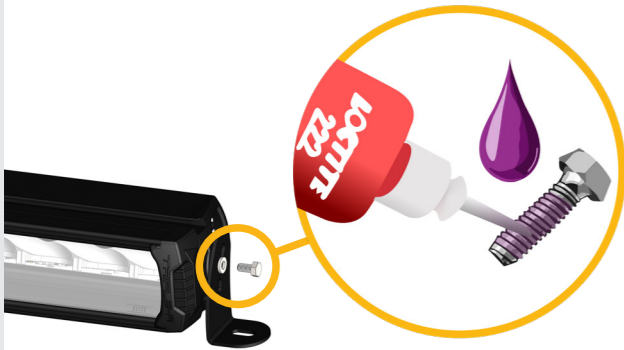

INSTALLATION PROCESS - Install should be completed with the grille left on the vehicle.

1 [Image showing the grille with four mounting points labeled 1, 2, 3, and 4.]

2 [Image showing a hand holding a black mounting bracket labeled 2.]

6 [Image showing the LED light being inserted into the grille housing, with a yellow circle highlighting the bracket area.]

2 [Image showing a hacksaw cutting an outboard guide, labeled "Outboard cutting guides (1&4)."]

7 [Image showing a drill with a 3.5mm bit, labeled "Ø3.5mm".]

8 [Image showing a screw being inserted into the grille, labeled "Screw cover" and "x6".]

3 [Image showing a hacksaw cutting an inboard guide, labeled "Inboard cutting guides (2&3)."]

5 [Image showing a torque wrench being used on a fastener, labeled "Torque info to the right."]

4 [Image showing a 10mm gap being measured between the grille and the light housing, labeled "10mm".]

TORQUE VALUES

The code is written on the inside of each bracket (see example).

CODE: LHIB TORQUE: 8 NM
CODE: RHIB TORQUE: 8 NM
CODE: LHOB TORQUE: 3 NM
CODE: RHOB TORQUE: 3 NM

90RHIB