

ELECTRICAL CONNECTION

Wiring information for **Triple-R 1000 Beacon** and **Triple-R 1000 Elite i-LBA** lamps are included in the lamp box.

★ — The red wire (Pin 30) connecting to the battery will need to be extended (cable and butt connector included).

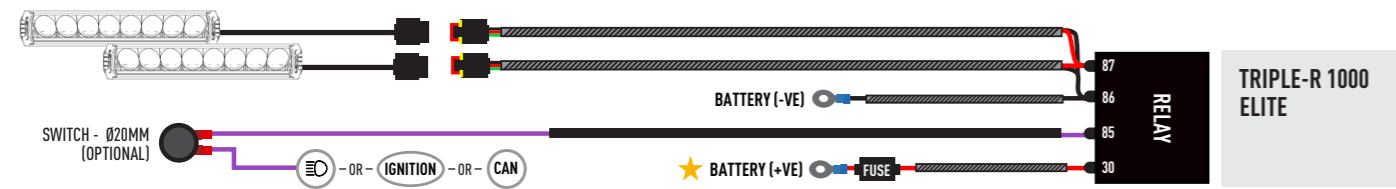
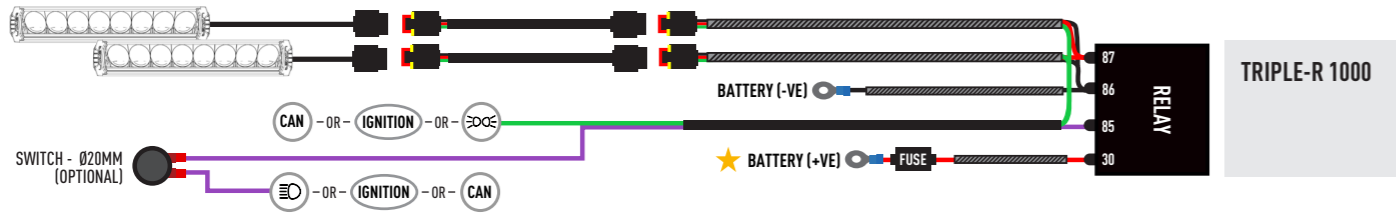

LAMP CONNECTOR INFORMATION

TRIPLE-R POSITION LIGHT FUNCTION (OPTIONAL)

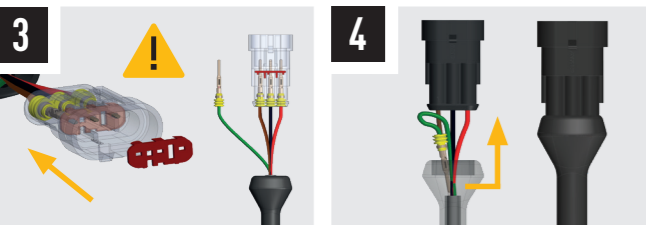
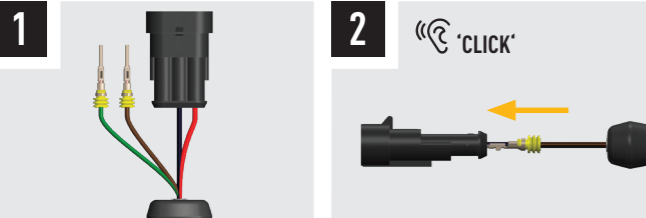

CANBUS INTEGRATION (SOLD SEPERATELY)

For vehicles where it is not possible to locate a 12V high beam signal, it will be necessary to take the high beam signal from the vehicle's CAN system. For connection options please visit the Lazer Lamps website, or contact your nearest dealer.

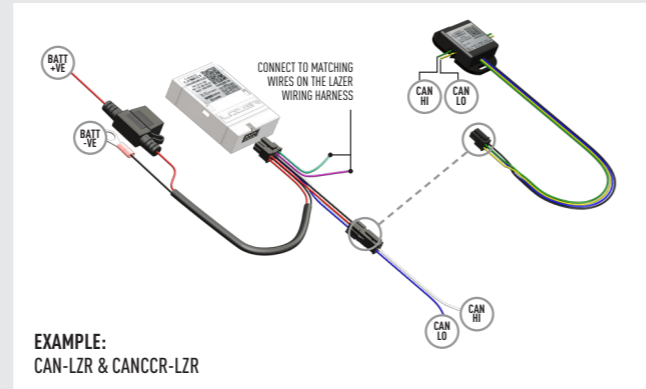

E9 UNECE REGULATIONS

Please scan the QR code to view all UNECE Certificates and information.



LAZER

HIGH PERFORMANCE LIGHTING

CHEVROLET SILVERADO 2500/3500 LT (2020-2023) GRILLE KIT

FITTING INSTRUCTIONS



LAZER

HIGH PERFORMANCE LIGHTING

WWW.LAZERLAMPS.COM

We appreciate your purchase of a Lazer Lamps product, and value your feedback. If you would like to leave feedback on your Lazer experience, please head to the relevant product page on our website www.lazerlamps.com.

T +44 (0) 1992 677374
E sales@lazerlamps.com

Lazer Lamps Ltd, Calder House, Central Road
Harlow, Essex, CM20 2ST, UK

MADE IN THE UK /LAZERLAMPS

WHAT'S INCLUDED

- 4x Grille Mounting Brackets
- 4x Cutter Guides
- Anti-Theft Fasteners & Key
- Fitting Instructions

Additionally - Kit Includes:

- 2x Triple-R 1000 LED Lights
- 1x Two-Lamp Wiring Kit

TOOLS REQUIRED

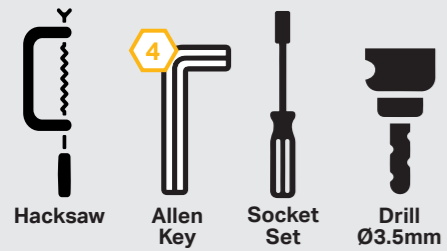

SIDE MOUNTING INFORMATION

Please use a thread seal compound (i.e. Loctite 222) to protect the lamp fastener from binding over time. See our T&Cs for more information.

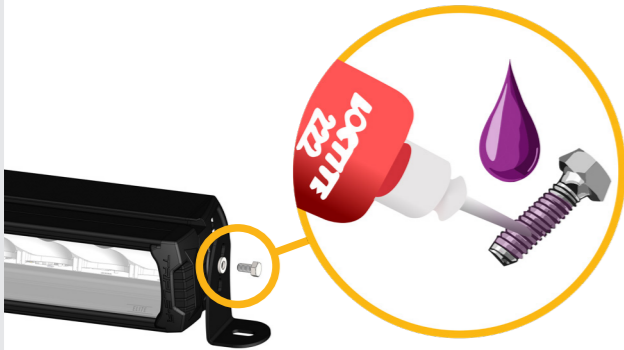

INSTALLATION PROCESS - Install should be completed with the grille left on the vehicle.

1 Marking the grille with cutter guides (1, 2, 3, 4) and a mounting bracket (2).

2 Making an **Outboard cut.** and an **Inboard cut.**

3 A **10mm** gap is shown between the grille and the mounting bracket.

4 The LED light is inserted into the bracket.

5 Torque info to the right.

6 The LED light is inserted into the grille.

7 A **Ø3.5mm** hole is drilled into the grille.

8 A screw is inserted into the hole (x4).

9 The screw is tightened to secure the light.

TORQUE VALUES

The code is written on the inside of each bracket (see example).

CODE: LHOB TORQUE: 3 NM
CODE: RHOB TORQUE: 3 NM
CODE: LHIB TORQUE: 8 NM
CODE: RHIB TORQUE: 8 NM
91RHIB